

**WHEN THE CEILING GRID PASSES OVER THE WALL
DOUBLE LAYER STONE WOOL PLENUM BARRIER**

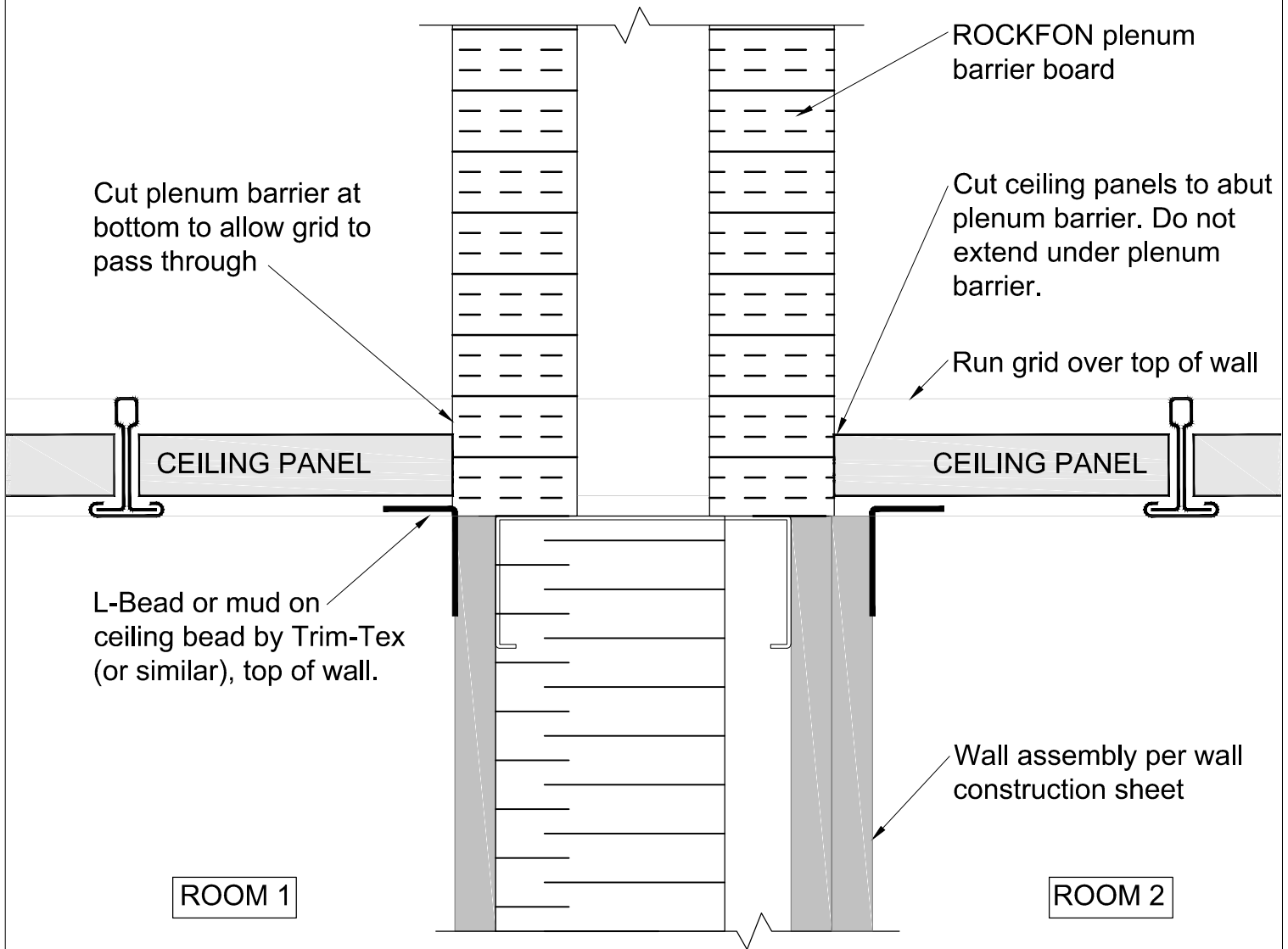

4849 South Austin Avenue
Chicago, IL 60638
www.rockfon.com

Toll Free: (800) 323-7164 (prompt #2)
Fax: (708) 563-4214
techservices@rockfon.com

Stone Wool Plenum Barrier
Continuous Grid STC 50

ORIG. DWG. DATE: 7/22/2017

DWG. BY: JLS

APPROVAL: _____

REV.:

REV. DATE:

SCALE:

6" = 1'-0"

DWG. NO.:

STC 50 CG