

A-A

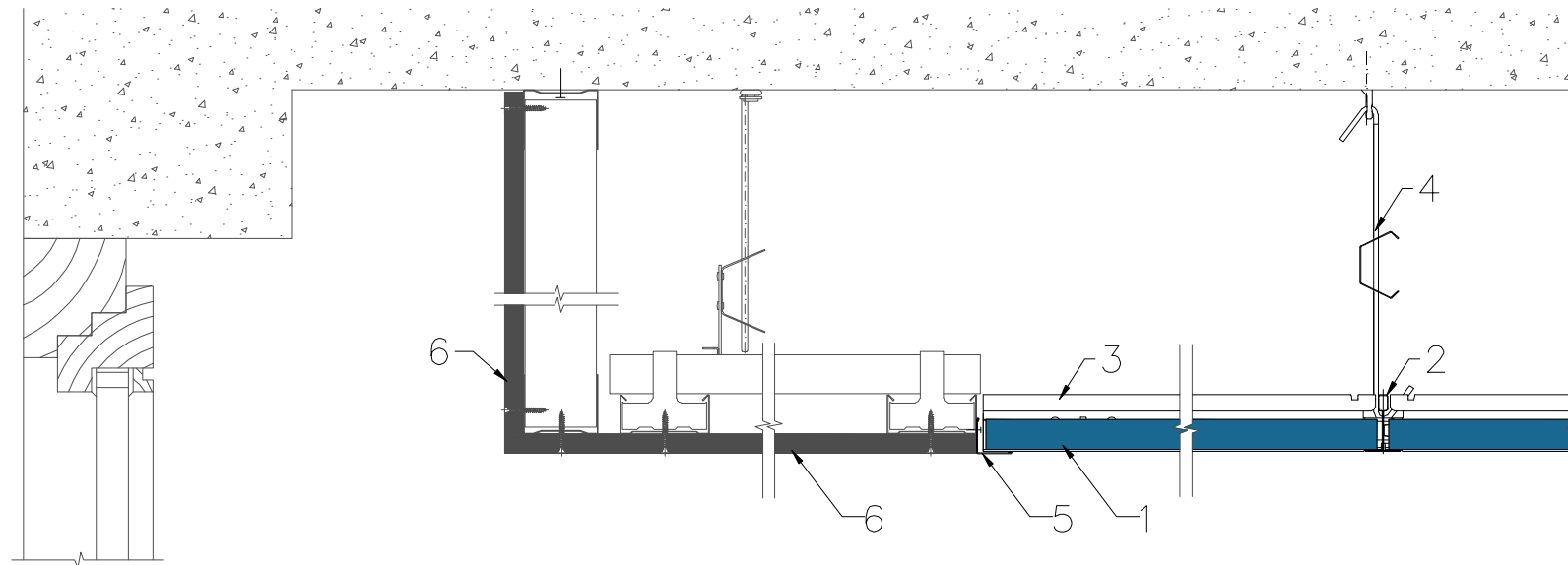

1. Tile ROCKFON, edge A
2. Mainrunner T24 C/H38 3600 white
3. Cross Tee T24 C38 600 white
4. Adjustable hanger
5. Wall Angle 24/24 3050 white
6. Gypsum Frieze

All screws and other fastenings shown are indicative and illustrative only.  
Specific fasteners should be chosen dependent on substrates and materials being used.

Information:  
Light from windows – gypsum perimeter finish vertical

Date:  
11.04.2014

Drawing Type:

Drawing No.:  
3.2.1.Light-incidence

Drawn by:

Scale:  
1:5

Contact Information:

We kindly draw your attention to the fact that the above drawings should be considered as guidelines and therefore are without responsibility on the part of Rockfon.

**Rockfon**<sup>®</sup>