

Rockfon® Infinity™ Perimeter Trim Installation Details

Introduction

Rockfon® Infinity™ is an excellent choice for finishing off the perimeters of your ceiling installation or for creating free-floating acoustical islands or clouds. Pair Rockfon Infinity with Chicago Metallic™ suspension systems or Rockfon metal ceilings to create unique visuals or smooth aesthetics. Rockfon Infinity is extruded aluminum, creating a sturdy, smooth, corrosion-resistant perimeter solution. Infinity is available in straight 12 ft. sections or as fully engineered factory cut solutions made to your specifications. Engineered

solutions come complete with shop drawings and individually marked sections ready to assemble once it arrives at the job site. Each straight 12 ft. section comes with 6 grid attachment clips (430.00), and straight splice clips (414.00) for each end. Corner clips must be ordered separately. Regardless of which solution is chosen, use care when handling the sections to prevent damage to the finished surfaces.

1. Corner Kits

To simplify infield fabrication, Rockfon offers 90 degree corner kits in both inside and outside configurations. Corner kits are available in 2 in., 4 in. and 6 in. that come pre-mitered with all the clips necessary for assembly. The corner kits allow for only straight cuts to be made infield, minimizing errors and reducing scrap.

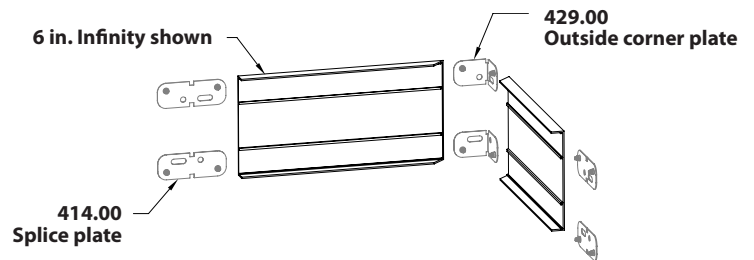

2. Suspension

Infinity integrates with all Chicago Metallic suspension systems. Install all suspension per ASTM C636 and local building codes. Additional hanger wires are required to support any cantilevered grid. This includes both the cross tees and the main runners. A typical acoustical island layout is shown below for an 8 ft. x 8 ft. installation. The wires shown in blue are the additional wires required on the cantilevered grid sections.

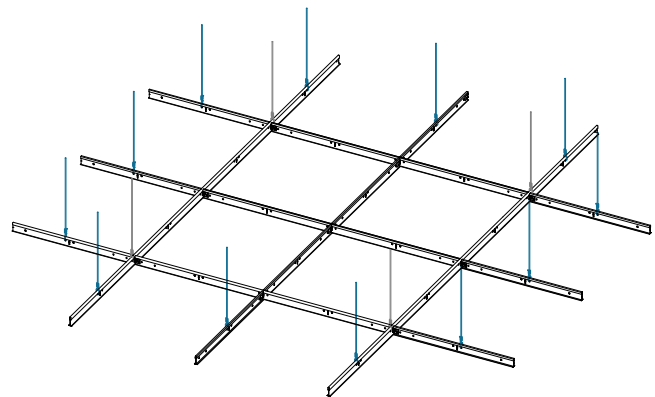

Rockfon® Infinity™ Perimeter Trim Installation Details

3. Infinity Design

All Infinity is manufactured from durable extruded aluminum. The design of the profiles includes a continuous double groove feature that allows for universal Rockfon clips, brackets and accessories. 2 in. profiles and razor profiles have one set of vertical

grooves, whereas profiles 4 in. and greater profiles have two sets of grooves. The straight splice plates, corner bracket and grid connector brackets all attach to these same grooves. Razor profiles include a similar horizontal feature for connecting the corners to insure a crisp clean corner on the long horizontal face.

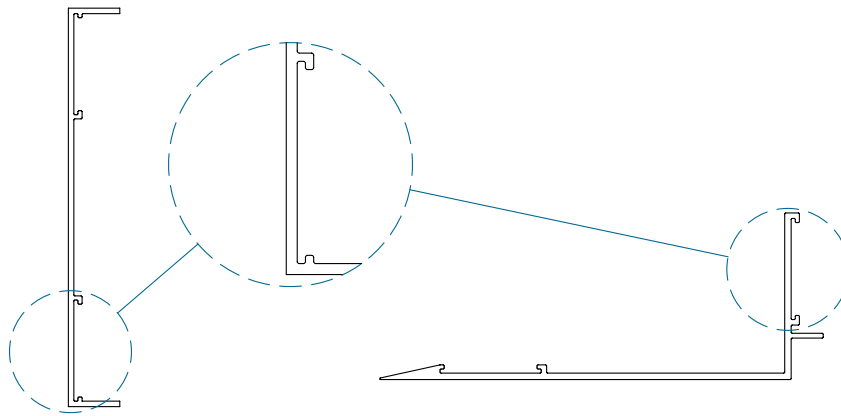

4. Cutting Infinity

Cutting Infinity is easy with a circular saw or a miter saw with an appropriate metal cutting blade; for accuracy of cuts, a miter saw is recommended. Use all appropriate personal protective equipment, as well as all appropriate safety precautions. Place the Infinity firmly against the saw's back stop. Once the blade is at full speed, slowly cut the component. Pushing the saw too quickly will result in sharp edges and poor cut quality.

Note: Maintaining a sharp blade is crucial to clean cuts. Be cautious of the cut edges as burrs and cut edge may be extremely sharp.

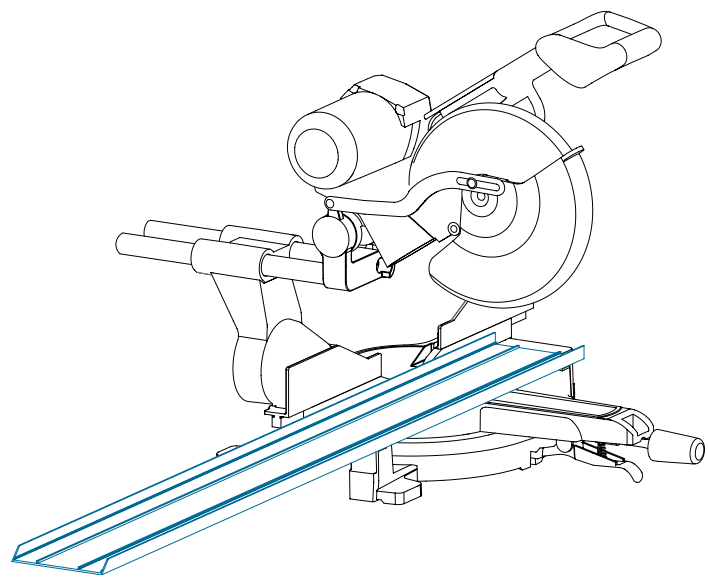

Rockfon® Infinity™ Perimeter Trim Installation Details

5. Infinity Integration with Suspension

Cross sections below show the typical installation details where the grid components and the Infinity meet. Note that some configurations use the 430.00 grid attachment clip in one orientation, while the others use the clip inverted.

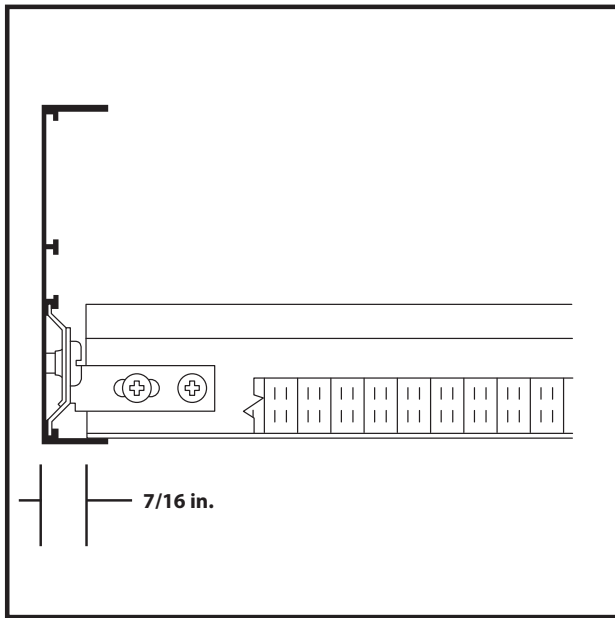

Infinity

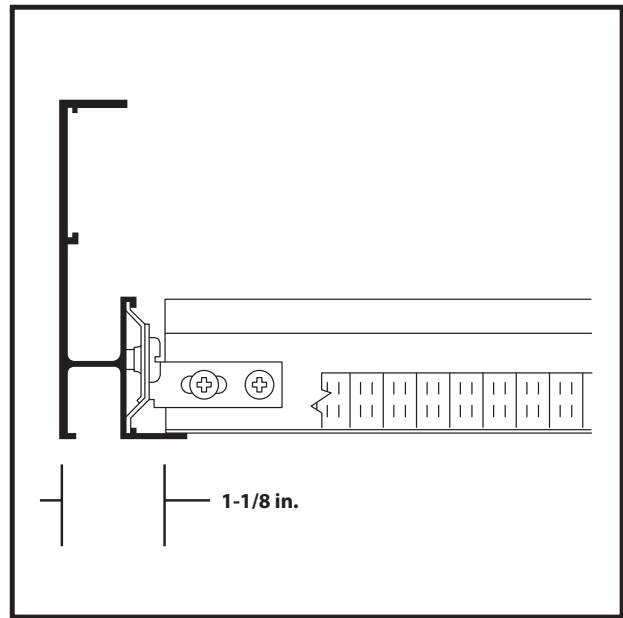

Infinity R (Reveal)

Rockfon® Infinity™ Perimeter Trim Installation Details

5. Infinity Integration with Suspension (continued)

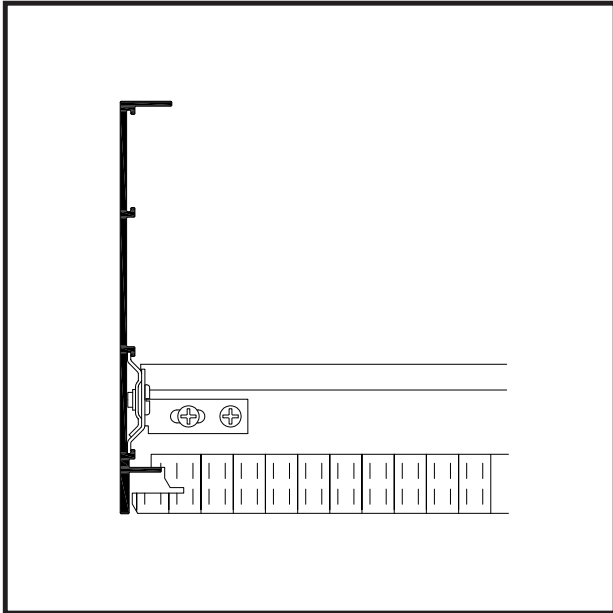

Infinity Concealed

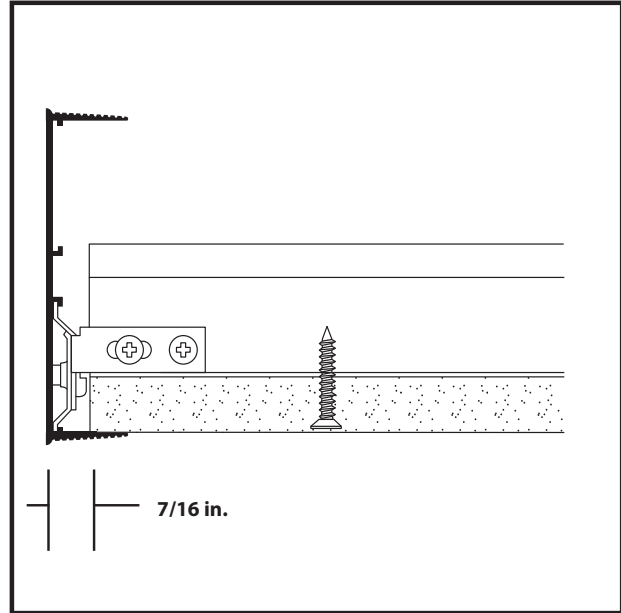

Infinity D (Drywall)

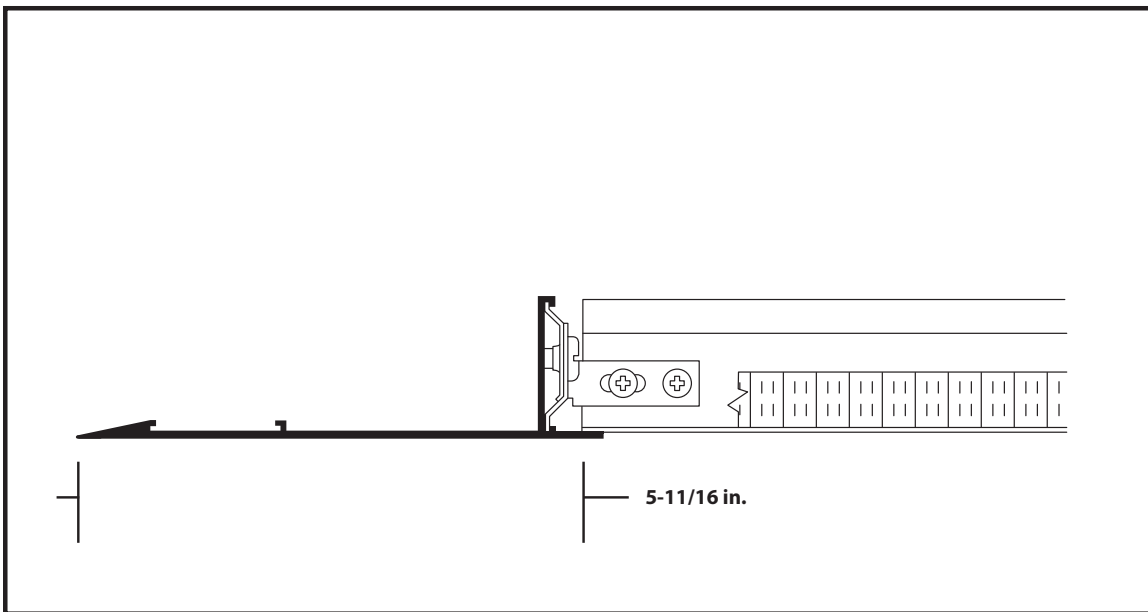

Infinity Z (Razor Edge)

Rockfon® Infinity™ Perimeter Trim Installation Details

5. Infinity Integration with Suspension (continued)

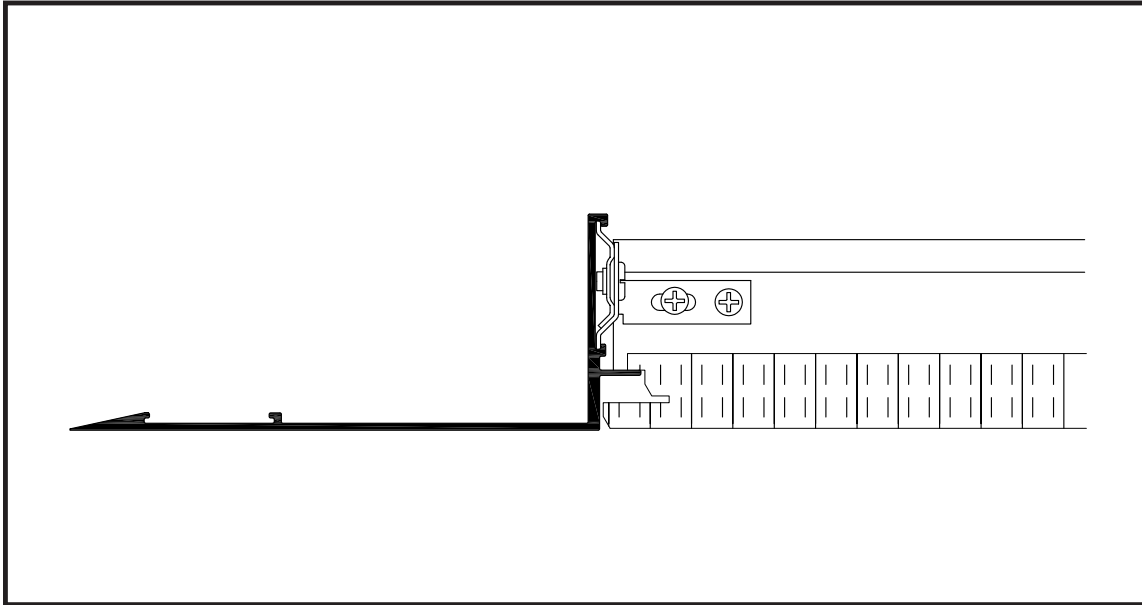

Infinity Concealed Razor

6. 430.00 Grid Attachment Clip

The 430.00 grid attachment clip is a universal clip that integrates with the double groove features. The design allows for the grid attachment clips to be inserted anywhere along the length of the Infinity, positioned, then tightened. The two-piece design of the clip works by expanding as the screw is tightened. The clip then locks into the groove feature of the Infinity profile. Adjustments are easy: simply loosen the screw, reposition and re-tighten. The two holes on the tab are for attaching the grid components. Best practice is to drive a screw into the oval slot first, this allows for minor adjustments by loosening the screw and sliding the grid. Once the position is finalized drive a screw through the round hole into the web of the grid, locking the position.

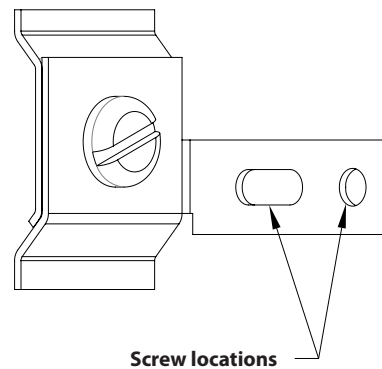

Rockfon® Infinity™ Perimeter Trim Installation Details

6. 430.00 Grid Attachment Clip (continued)

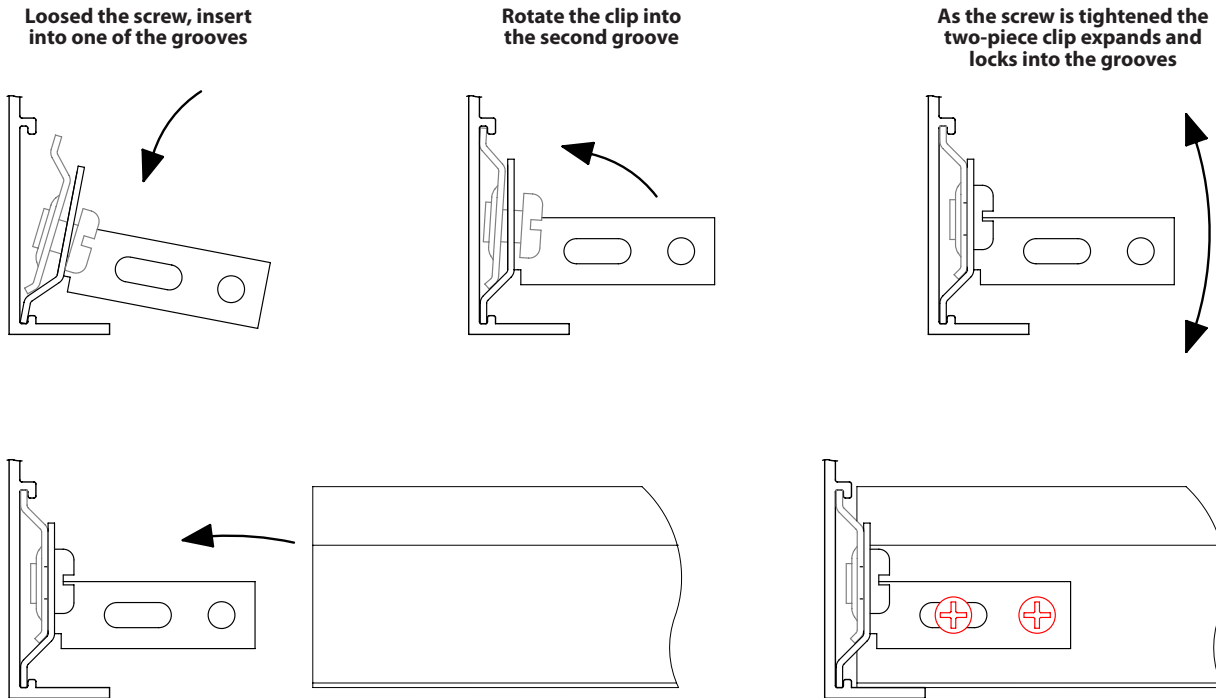

7. Corner Clips and Splice Plates

Joining sections of Infinity or creating corners is easy utilizing the proper connector clip. All of the connector clips work the same by sliding into the double groove feature on the Infinity and securing with the set screws. Do not over tighten the set screws; doing so will result in distortion of the outside finished surface of the trim.

The corner clips require properly mitered sections of Infinity. Corner clips can also be utilized when terminating Infinity at walls. Remove the set screw and utilize this hole along with the second hole to secure to the wall.

Note: 4 in. and greater profiles require two clips per intersection.

414.00: Splice plate

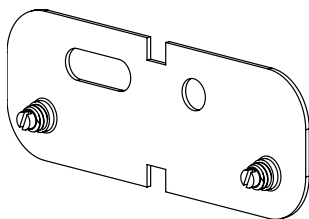

417.00: Inside corner

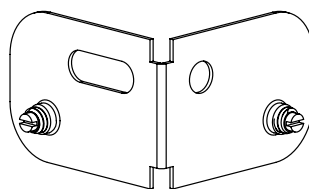

429.00: Outside corner

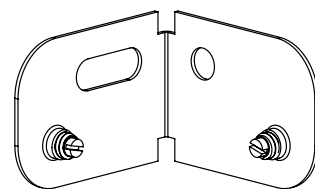

Rockfon® Infinity™ Perimeter Trim Installation Details

7. Corner Clips and Splice Plates (continued)

- 7.1 Slide the first end of the clip into one half of the joint, centering the clip at the joint.
- 7.2 Tighten the set screw on the first half.

- 7.3 Slide the mating section of Infinity.
- 7.4 Tighten remaining set screws (Do not over tighten).

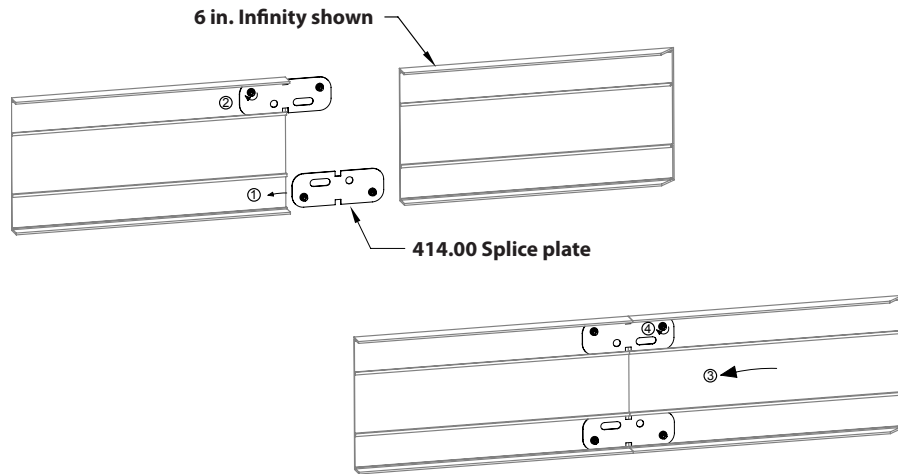

8. Special Splice Plate

Razor profiles require special attention at the corners. The long razor edge of the perimeter trim and the distance from the corner brackets can create poor corner aesthetics. To prevent this issue, use the groove features on the horizontal surface of either the standard razor or the concealed razor, along with the 447.00 horizontal splice plate, to align the outside edge of the trim.

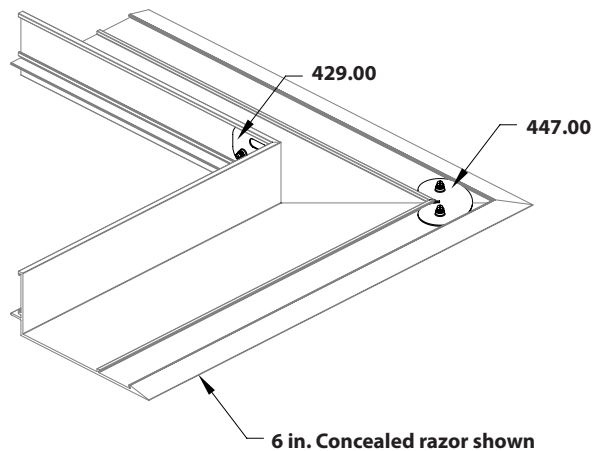

Rockfon® Infinity™ Perimeter Trim Installation Details

9. Bracing Tall Profiles

For profiles 8 in. and taller, it is recommended to brace the profile utilizing sections of grid and additional 430.00 clips. The brace is created by attaching a short section of inverted grid between the upper groove feature and the grid profile as shown below. All grid components must have a hanging wire within 12 in. of the Infinity profile.

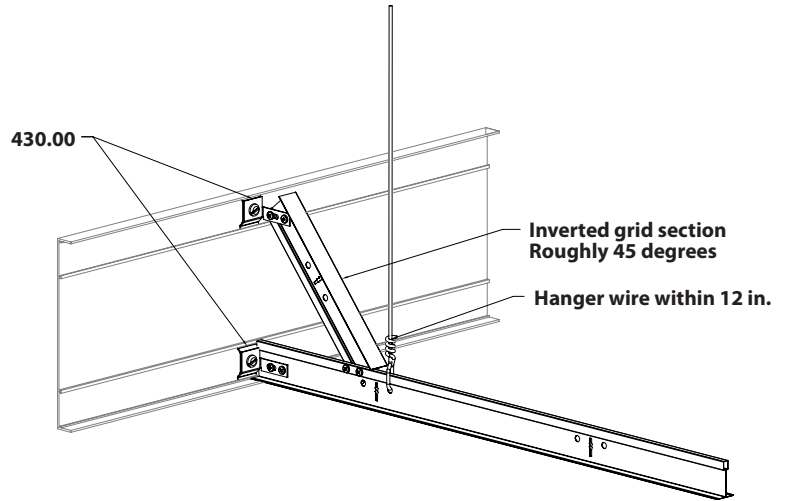

10. Paired Infinity

Creating a dramatic look with paired Infinity is simple utilizing 446.36 (3/4 in. opening) or 446.46 (1-3/8 in.). Clips need to be placed every 2 ft. along the Infinity,

alternating top and bottom. Hanger wires need to be installed on 4 ft. centers, with wires near the ends of a linear pair (2 ft. or less).

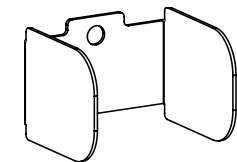

446.36.00
3/4" Opening

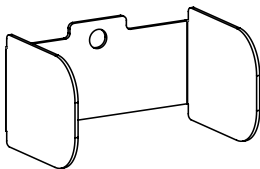

446.46.00
1-3/8" Opening

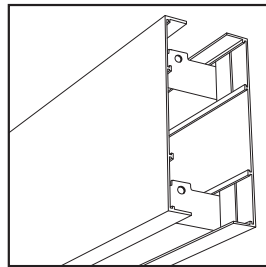

Paired Infinity Bracket

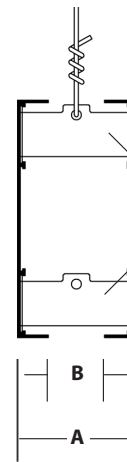

#446 Brackets
(Stagger top and bottom)

446.36.00
A = 2-1/4" panel to panel face
B = 3/4" open between panels

446.46.00
A = 2-7/8" panel to panel face
B = 1-3/8" open between panels

Panel Spacing

Have questions?

Contact the Rockfon Technical Services Team by calling 800-323-7164 and we can provide assistance on your project.

Rockfon | 4849 S. Austin Ave., Chicago, IL 60638 USA

Tel. +1-800-323-7164 | Fax. +1-800-222-3744 | www.rockfon.com | cs@rockfon.com | 07-2017