

## Chicago Metallic® 730 Stainless Steel 15/16"

Acoustical ceiling suspension system



Ideal for: Food preparation, laboratories, or laundries.

Performance Properties:

- Designer grid system features an intermediate-duty design with hook-end cross tees
- Acoustical ceiling system uses 304 stainless steel design and 2B Finish Stainless steel capping
- Sturdy stainless steel grid construction provides superior corrosion resistance
- All system components are shipped with strippable plastic film to protect exposed grid face
- Chicago Metallic® suspension systems meet a Class-A flame spread rating in accordance with ASTM standard E1264-08

# Chicago Metallic® 730 Stainless Steel 15/16"

## LEED® V4 HIGHLIGHTS

### Materials and Resources (MR)

- Waste Management Planning
- Interiors Life Cycle Impact Reduction
- Environmental Product Declarations
- Sourcing of Raw Materials
- Material Ingredients
- Waste Management

### Indoor Environmental Quality (EQ)

- ✓ -Low-Emitting Materials
- ✓ -Interior Lighting
- ✓ -Acoustic Performance

RECYCLED CONTENT: UP TO: 0%

| Detail  | Product Number | Length | Height (A) | Face (B) | Grid Coupling Type | Slotting / Class | Fire Rated | Seismic | Recycled Content |
|---|----------------|--------|------------|----------|--------------------|------------------|------------|---------|------------------|
| <b>Main Runners</b>   |                |        |            |          |                    |                  |            |         |                  |
|  | 730.00SBZ      | 144"   | 1-1/2"     | 15/16"   | Knuckle-End        | 12" OC, ID       | -          | C       | -                |
| <b>Cross Tees</b>   |                |        |            |          |                    |                  |            |         |                  |
|  | 732.00SBZ      | 24"    | 1-1/2"     | 15/16"   | Hook-End           | No Slots         | -          | C       | -                |
|   | 734.00SBZ      | 48"    | 1-1/2"     | 15/16"   | Hook-End           | 12" OC           | -          | C       | -                |
| <b>Wall Angles &amp; Channels</b>   |                |        |            |          |                    |                  |            |         |                  |
|  | 1490.00SB      | 144"   | 3/4"       | 15/16"   | -                  | -                | -          | C       | -                |

# Packaging

| Product Number                    | Pieces per Carton | Ft per Carton | Lbs per Carton | Cartons per Pallet  | Lbs per Pallet      |
|-----------------------------------|-------------------|---------------|----------------|---------------------|---------------------|
| <b>Main Runners</b>               |                   |               |                |                     |                     |
| 730.00SBZ                         | 20                | 240           | 62.4           | 30                  | 1872                |
| <b>Cross Tees</b>                 |                   |               |                |                     |                     |
| 732.00SBZ                         | 20                | 240           | 62.4           | 30                  | 1872                |
| 734.00SBZ                         | 60                | 240           | 60             | 30                  | 1800                |
| <b>Wall Angles &amp; Channels</b> |                   |               |                |                     |                     |
| 1490.00SB                         | 25                | 300           | 44             | Palletized to Order | Palletized to Order |

# Accessories

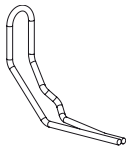

416.15  
Intersection Clip  
for Hook-end  
Cross Tees  
1000 PCS/Carton

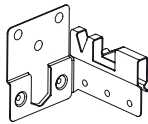

1496.00  
Seismic  
Perimeter Clip  
100 PCS/Carton

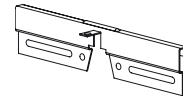

1494.00  
Seismic  
Separation Clip  
100 PCS/Carton

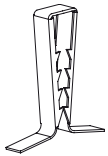

935.00  
Hold Down Clip  
for Various  
Height Panels  
1000 PCS/Carton

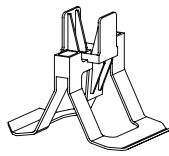

490.00  
Hold Down Clip  
for 0" – 3/4" Panels  
100 PCS/Carton

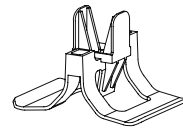

491.00  
Hold Down Clip for  
3/4" – 1-1/4" Panels  
150 PCS/Carton

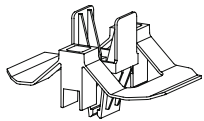

492.00  
Hold Down Clip  
for 1-1/2" Panels  
100 PCS/Carton

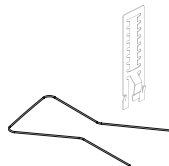

495.00  
Facett™ Hold  
Down Clip for  
2" – 4" Panels  
100 PCS/Carton



826.00H  
2' Spacer Bar  
80 LF/Carton



828.00H  
4' Spacer Bar  
160 LF/Carton



824.00H  
4' Spacer Bar,  
Notched at 2'  
160 LF/Carton

# Performance

## Component Load Test Data and Material

| Allowable Load per ASTM C635 |        |       |                |     |     |
|------------------------------|--------|-------|----------------|-----|-----|
| Main Tee                     | Length |       | Hanger Spacing |     |     |
|                              |        |       | 4'             | 5'  | 6'  |
| 730.00SBZ                    | 144"   |       | ID             | 6.0 | 4.0 |
| Cross Tee                    | Length | 2'    | 4'             |     |     |
| 732.00SBZ                    | 24"    | 75.0♦ |                |     |     |
| 734.00SBZ                    | 48"    |       | 13.3           |     |     |

To convert data into lb/ft<sup>2</sup>, divide on center spacing of component into lb/ft.

♦ Limited by safety factor of 2.

## Light Fixture Load Test Data (based on 1/360 span deflection)

| Light Fixtures<br>Dimensions | Main & Cross Tees - Allowable Fixture Weight - Pounds |           |
|------------------------------|---|-----------|
|                              | 730.00SBZ   | 734.00SBZ |
| 1' x 4'                      |   | 55.6      |
| 2' x 2'                      |   | 49.6      |
| 2' x 4'                      |   | 64.0♦     |

♦ Limited by safety factor of 2.

## Non-Fire Rated Assemblies

### Hanger Positions for Non-Fire Rated Situations

This illustrates hanger positions for single fixtures in a field. Provide extra hangers for tandem fixtures.

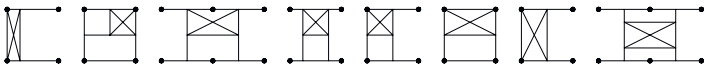

## Material

ASTM C 635 Intermediate Duty (ID) main tee classification, Type 304 commercial quality stainless steel. 15/16" wide bottom flange with Type 304 alloy, 2B finish stainless steel capping.

Note: A metallurgist should be consulted regarding the suitability of this product for the environmental conditions in which it is being installed.

## Compatible Tile Edge Types

730 System

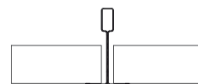

SQ

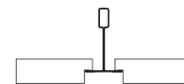

SL

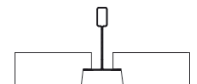

SLT

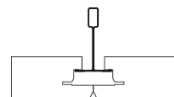

CDX

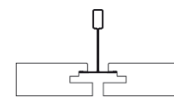

SCD

Rockfon® is a registered trademark  
of the ROCKWOOL Group.

10.2018 | All colour codes mentioned are based on the NCS - Natural Colour System® property of and used on license from NCS Colour AB, Stockholm 2012 or the RAL colour standard. Subject to alterations in range and product technology without prior notice. Rockfon accepts no responsibility for printing errors.



**Rockfon**  
4849 S. Austin Ave., Chicago, IL 60638 USA  
Tel. +1-800-323-7164  
Fax. +1-800-222-3744  
[www.rockfon.com](http://www.rockfon.com)  
[cs@rockfon.com](mailto:cs@rockfon.com)  
SNL150024